

REGISTRATION INFO:

2009 South Judges Cup

ENTRY FEE: \$75 all levels

BONUS DEADLINE: September 5th

EARLY BIRD DEADLINE: September 12th

ENTRY DEADLINE: September 19th (no refunds after this date)

Send CHECKS, ROSTER and CONTACT INFO to:

South Judges Cup c/o Cathy Peebles 111 S. Old Covered Bridge Lane Springfield IL 62711

Make Check Payable to: **IL NAWGJ** (one check per club)

We will verify all USAG numbers online. It is the club's responsibility to have CURRENT numbers by **September 2nd**. Sessions are scheduled for Saturday afternoon through Sunday evening. SCHEDULES will be determined once all rosters are received. You will receive an EMAIL NOTIFICATION of your session as soon as the schedule is set. Check the IL NAWGJ website often for updates

www.ilnawgj.com.

QUESTIONS and CONTACT NUMBERS:

Cathy Peebles 217-787-7004

DIRECTIONS and PARKING:

South Judges Cup will be held at Midstate Gymnastics Academy.
3720 Hollis Drive, Springfield , IL 62711

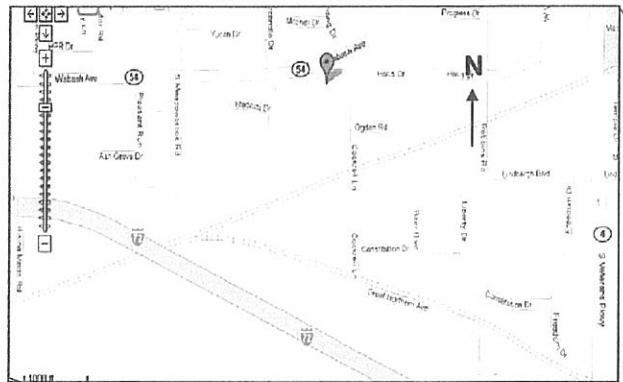

From North or South: Exit from 55 to 72 west. Take the Wabash exit. Turn right (east) at the ramp. Gym is approximately 2 miles down on the right.



REGISTRATION INFO:

ENTRY FEE: \$75 all levels

BONUS DEADLINE: September 19th

EARLY BIRD DEADLINE: October 3rd

ENTRY DEADLINE: October 17th (no refunds after this date)

Send CHECKS, ROSTER and CONTACT INFO to:

North Judges' Cup c/o Cyndi Zimmerman 1167 Milburn Ct., Naperville, IL 60540

Make Check Payable to: **IL NAWGJ** (one check per club)

We will verify all USAG numbers online. It is the club's responsibility to have **CURRENT** numbers by **October 1st**. Sessions are scheduled for Friday evening through Sunday evening. **SCHEDULES** will be determined once all rosters are received. You will receive an **EMAIL NOTIFICATION** of your session as soon as the schedule is set. Check the IL NAWGJ website often for updates www.ilnawgj.com.

QUESTIONS and CONTACT NUMBERS:

Cyndi Zimmerman: gymmom4@aol.com or 630-664-5530 or Glen Marks Elk Grove Gymnastics School 847-437-3447 **EMERGENCY PHONE NUMBER DAY OF MEET:** 847-630-9296.

DIRECTIONS and PARKING:

Judges' Cup will be held in UIC's PE Building. Located at 901 W. Roosevelt Rd. Chicago, IL. The building is located on the south side of Roosevelt Rd. between Halsted St. & Morgan St. **PARKING** is located in Lot 5C directly across the street from the PE Bldg. (north side of Roosevelt Rd.) Enter the parking lot from Morgan St. There is a charge for parking. Participants and spectators must park in Lot 5C.

2009 North Judges Cup

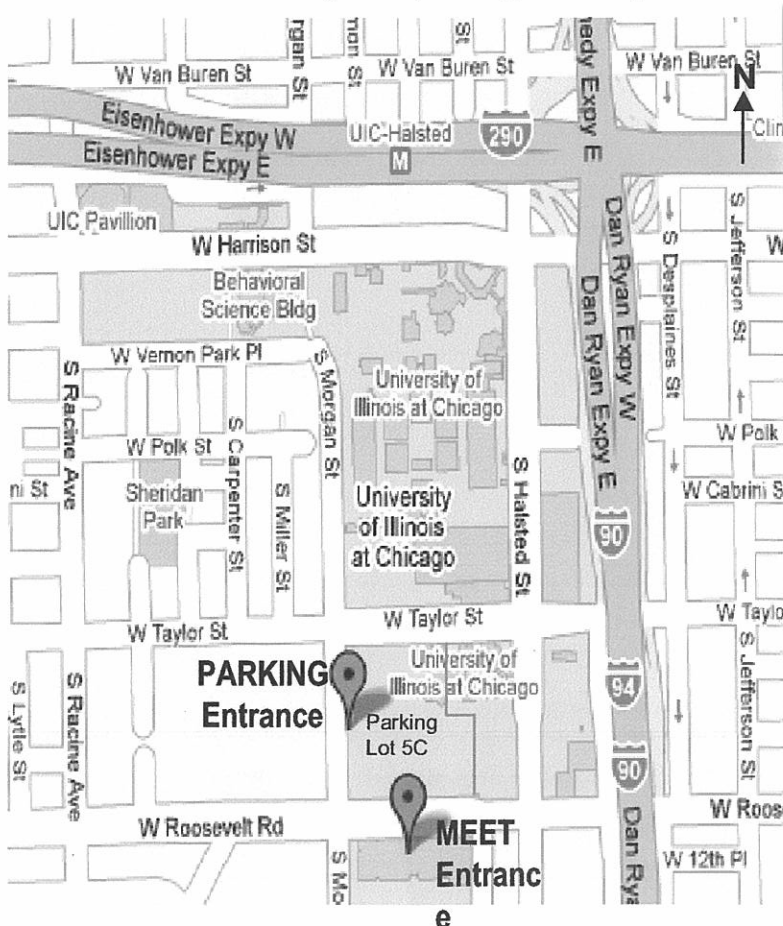

From the **NORTH**:

Take the Kennedy Expy. past the Eisenhower Expy. (I-290) Immediately exit at Taylor St. Go up the ramp and continue going south to Roosevelt Rd. Turn right on Roosevelt Rd.

From the **WEST**

Take the Eisenhower Expy to the Dan Ryan (90/94) towards Indiana Follow the ramp to the Dan Ryan. Immediately exit at Taylor St. Go up the ramp & continue going South to Roosevelt Rd. Turn right on Roosevelt Rd.

From the **SOUTH**

Take the Dan Ryan Expy. Exit at Roosevelt Rd. Turn left on Roosevelt Rd.

From the **SOUTHWEST (I-55)**

North on I-55 towards Chicago. Take 90/94 (towards Wisconsin). Exit at Roosevelt Rd. Turn left on Roosevelt Rd.